

# Monthly update – North Strathfield

26 February 2024

Sydney Metro is Australia's biggest public transport project.

The NSW Government is delivering Sydney Metro West – a new underground metro railway which will double rail capacity between Parramatta and the Sydney CBD, link new communities to rail services and support employment growth and housing supply.

Acciona Ferrovia Joint Venture (AFJV) has been awarded the contract to deliver 11 kilometres of twin metro rail tunnels between The Bays and Sydney Olympic Park and excavate five new metro stations, including a station at North Strathfield.

## Work during March

Work will continue within and around the North Strathfield Metro Station site during March. The main activities will include:

- Completion of retaining structures such as shotcrete walls and ground anchors
- Nozzle excavation and lining at the northern and southern ends of the station box
- Removal of excavator platform decks
- Installation of graphics on hoarding around the site boundary
- Utility work on Queen, Waratah and Pomeroy streets
- Delivery and removal of oversize equipment
- Line marking and signage installation work
- Taking readings from previously installed groundwater boreholes

This work will be carried out during standard construction hours:

- Monday to Friday 7am – 6pm and Saturday 8am – 6pm

## Work outside standard construction hours

Some of the road island restoration, utility work, concreting, hoarding graphics installation and maintenance as well as oversize deliveries must be undertaken outside standard construction hours to minimise impacts on traffic and to ensure the safety of motorists, pedestrians and workers. Night work will be carried out on no more than two consecutive nights, no more than three nights per week and no more than 10 nights per month at any one location.

This night work will continue to occur in the work area shown on the map overleaf between **8pm and 5am on Monday, Wednesday and Thursday nights from Monday 4 March until Friday 29 March 2024**. During March some of the work will occur within the existing rail corridor and must be carried out under possession weekends maintained by Sydney Trains on **Saturday 9 March and Sunday 10 March 2024**.

## What to expect

- There may be some noise associated with the work but we will try to minimise this as much as possible
- Property and business access will be maintained at all times
- Noise blankets will be used to minimise disturbance during night work
- There will be no disruption to supply of utility services
- Saw cutting and hammering work will be completed by midnight for night work

## Equipment used

Equipment used for this work includes but is not limited to: trucks, light vehicles, excavators, rattle guns, watercarts, concrete saws, bobcats, jack hammers, vacuum trucks, cranes, elevated work platforms, concrete trucks/pumps, street sweeper and hand tools.

### Changes to traffic, pedestrian and cyclist routes

Traffic control will be in place to assist motorists, pedestrians and cyclists at entry and exit points to the construction site. The utility investigation work taking place in the surrounding streets will require some temporary footpath closures. Traffic control will be in place to assist motorists around this work. At times electronic variable message signs will be used to advise motorists of changed traffic conditions and these may temporarily occupy parking spaces.

On **Monday 4 March, Wednesday 6 March (contingency) and Thursday 14 March 2024**, between 9pm and 5am only, Queen Street will be closed between Wellbank and Pomeroy streets for line marking, signage installation and crane lifts of oversize equipment out of the station box. Local access will be maintained. Detours will be in place via Wellbank Street, Concord Road and Beronga Street. Traffic control will be in place to assist motorists. In preparation for this night work traffic control will be in place from 6am each day to reserve parking.

### North Strathfield work area

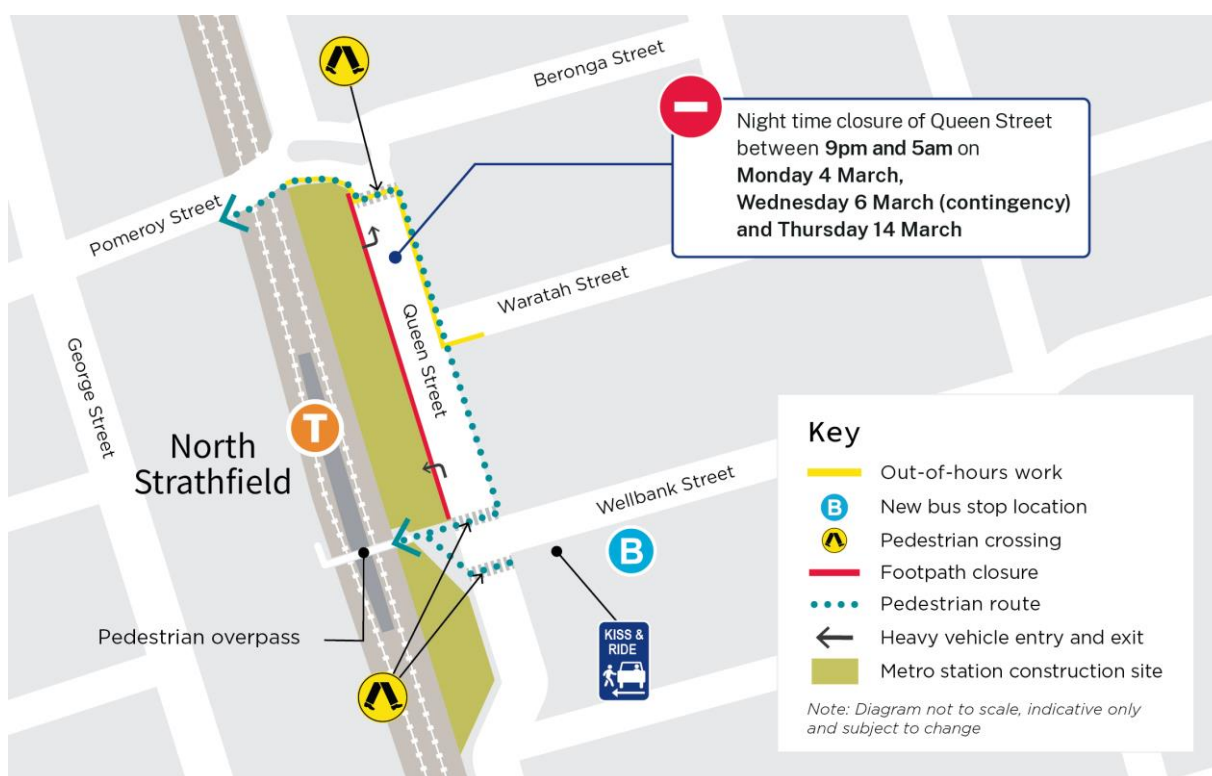

### Contact us:

Please contact Liz from the community team on **1800 612 173** if you have any questions, complaints or would like to provide feedback about the work. We will continue to keep you updated on the progress of work in your area. If you would prefer to receive updates by email, please send a request to [metrotunnelsAFJV@transport.nsw.gov.au](mailto:metrotunnelsAFJV@transport.nsw.gov.au) and we will add you to the distribution list.

Sydney Metro has launched Sydney Metro Connect – a new way to stay informed. You can download Sydney Metro Connect on the App Store or get it on Google Play. Thank you for your cooperation while we complete this essential work.

**1800 612 173** Community information line open 24 hours

[metrotunnelsAFJV@transport.nsw.gov.au](mailto:metrotunnelsAFJV@transport.nsw.gov.au)

Sydney Metro West, PO Box K659, Haymarket NSW 1240



Access information in over **100 languages**

Download **Sydney Metro Connect** from the App store or get it on Google Play.



If you need help understanding this information, please contact the Translating and Interpreting Service on **131 450** and ask them to call us on **1800 612 173**